

PRESIDENT'S REPORT

[2016-2017]

This report contains data from the 2016-2017 academic year

ENTRY

ADMISS
BUSINE

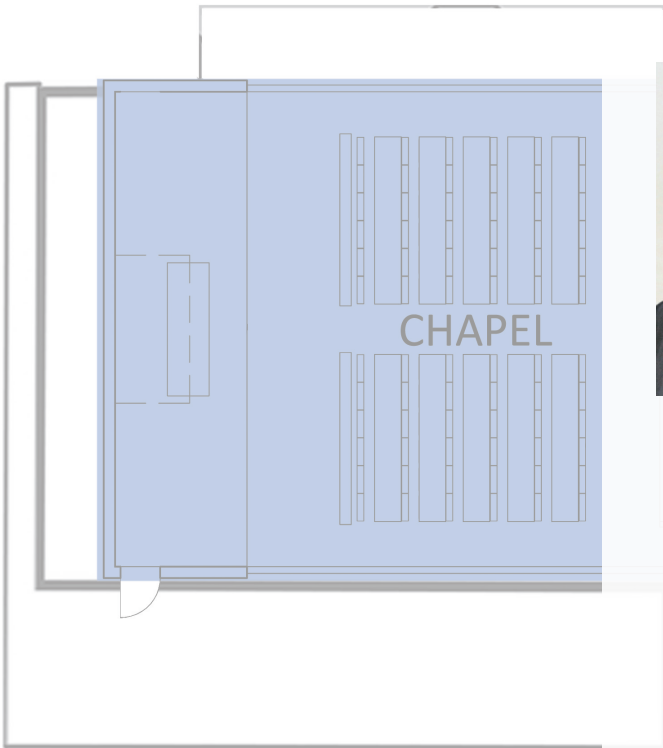

Monsignor Stuart Swetland

In early September, we were informed by *U.S. News & World Report* that we were being recognized as the Most Diverse College in the Midwest. I must admit that keeping the honor a secret for a week while it was “embargoed” was extremely difficult!

This honor is an external recognition of what all those who work at or attend Donnelly College already know. Our College is wonderful and wonderfully diverse. Since its inception 68 years ago, Donnelly has been a model of inclusivity.

This accessibility is needed now more than ever. At a time when racial tensions are rising and both private and public colleges and universities are becoming more and more economically exclusive, the mission of Donnelly College is of vital importance.

ENTRY

MAIN
LOBBY

DONOR
WALL

BOOKSTORE
DISPLAY

CAMPUS ASSEMBLY

LOUNGE

CAMPUS QUAD

BISTRO

SIONS
SS/F.A.

STUDENT
SERVICES

This is why we continue to increase our programs and offerings at Donnelly College. Starting in January, we will enroll our first class of Registered Nurse - Associate of Nursing (RN-ADN) students. We have also entered into exciting new grant and scholarship partnerships with University of Missouri - Kansas City, University of Kansas, Kansas State University, Avila University, the Kauffman Foundation, KC Scholars, the Department of Defense and the Department of Education.

Perhaps the most exciting news is the approval of our new Campus Master Plan. By the time you read this, our renovation of Marian Hall will be complete and an additional 13,000 sq. ft. of academic and office space will have been added to our college. (Please join us for the rededication ceremony for Marian Hall on January 25, 2018 at 4 p.m.)

Donnelly College must succeed at our mission if we are to fulfill Pope Francis's call to be joyful proponents of the gospel of life, especially for those at the margins in our society. More than 75% of our students are first generation college students and their

average family income is less than \$29,000 a year. Most students could not attend college if Donnelly was not here for them.

Our mission is vital at this moment of our nation's history, but it is not possible without the generous support of our donors. This is a challenging time for us as we diligently work toward our upcoming Higher Learning Commission (HLC) accreditation visit. We know that the HLC will be looking to see how much the community supports our mission. They will examine our fiscal health and the viability to continue to heavily subsidize our students' Christian formation and education at Donnelly. For nearly 70 years, we have faithfully served our mission, modeling a partnership between dedicated, hardworking faculty, staff and students and a generous community willing to help others to climb the ladder of success and sanctity that all of us hope to ascend.

Pax,

Msr. Stuart W. Swetland

Monsignor Stuart Swetland
President

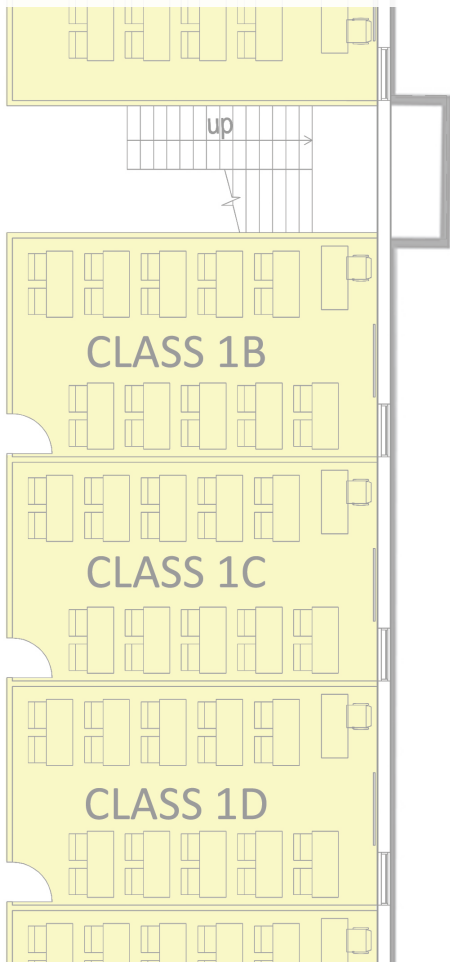
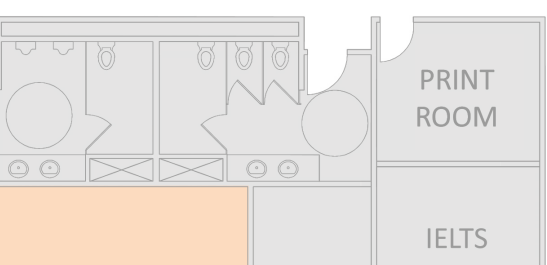
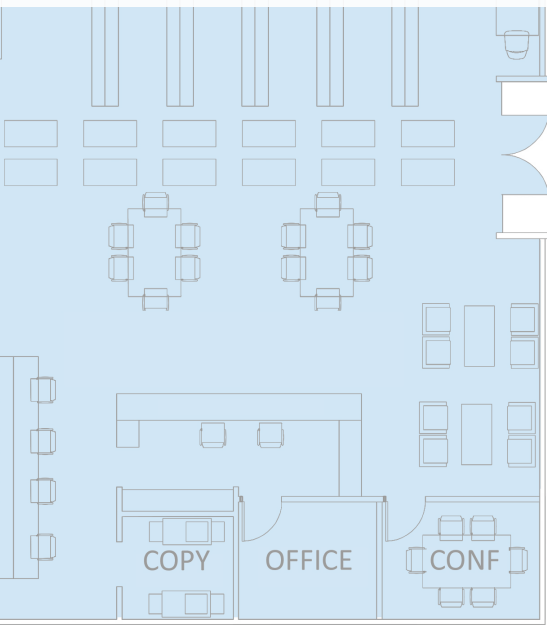

N 18TH STREET

ABOUT DONNELLY

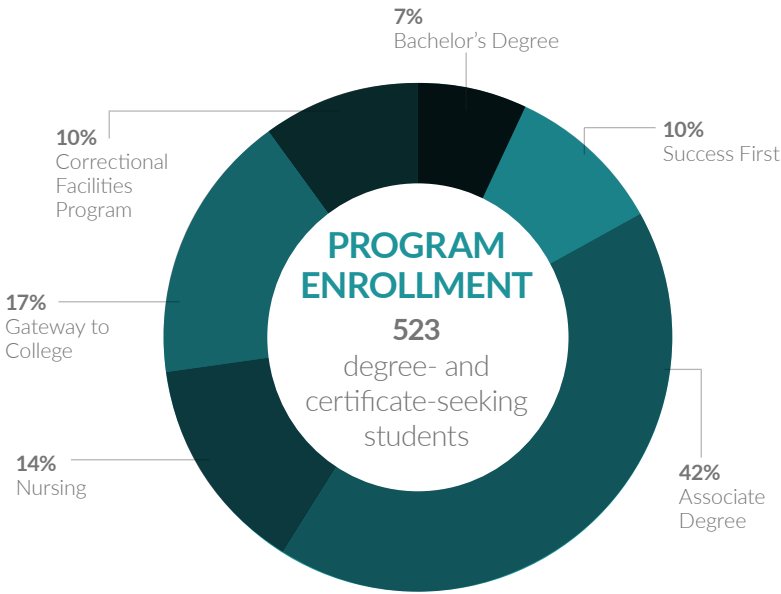

On average, Donnelly's classes have **12 STUDENTS**



WHO OUR STUDENTS ARE



35% male 65% female

63% full-time

37% part-time

75
PERCENT

first-generation college students
- almost twice as high as other four-year institutions nationally

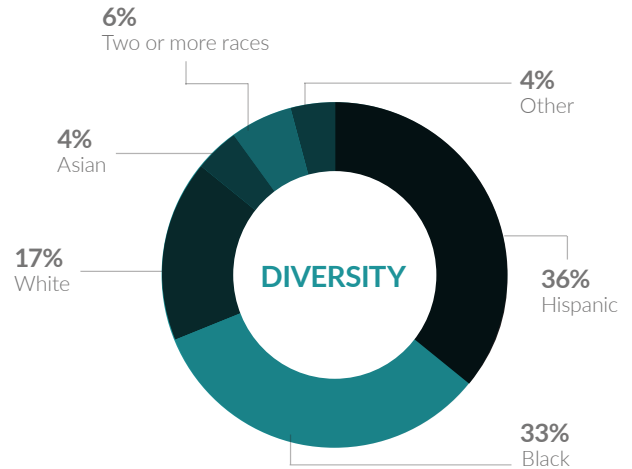

WHERE OUR STUDENTS COME FROM

59 total metro high schools represented by Donnelly's student body



308

An additional current high school students received credit through College Credit Now

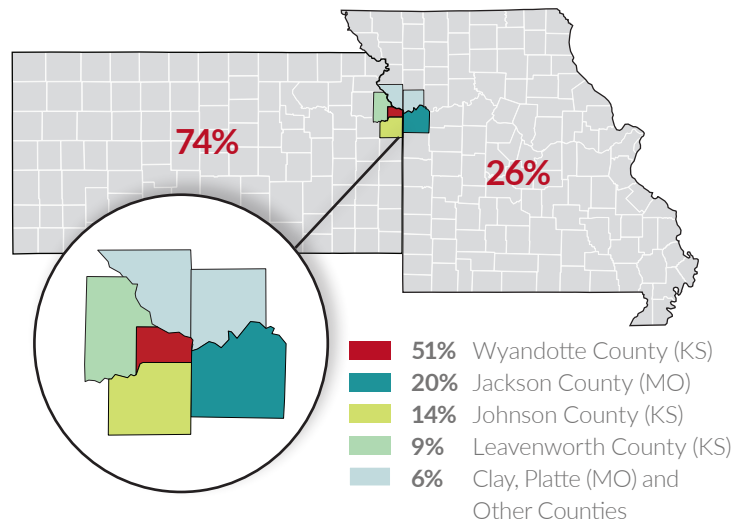

WE ♥ SCHOLARSHIPS

U.S. average Catholic College tuition and fees for a full-time student

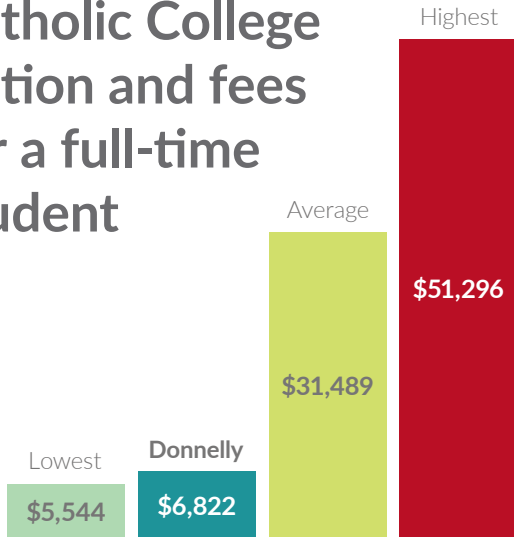

Source: Association of Catholic Colleges and Universities

65%
OF STUDENTS RECEIVE PELL GRANT ASSISTANCE
TOTALING
\$914,102
total Pell Grants distributed

\$3,777
average award

61%
OF STUDENTS RECEIVE SCHOLARSHIPS & institutionally-based aid
TOTALING
\$534,339
total scholarships and institutionally-based aid

\$2,333
average award

FINANCIAL INFORMATION

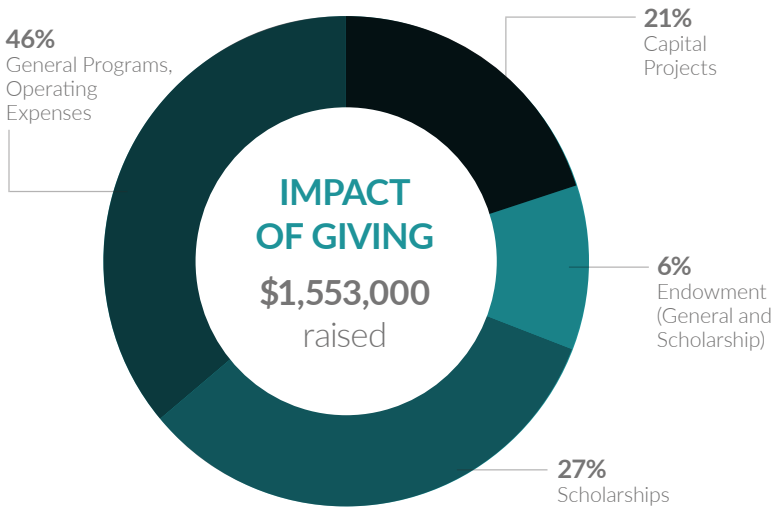

SOURCES OF GIFTS

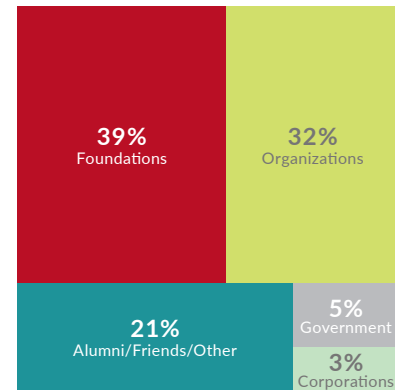

SOURCES OF OPERATING REVENUE

